

Ball Screw Double Nut Size Specification DFU

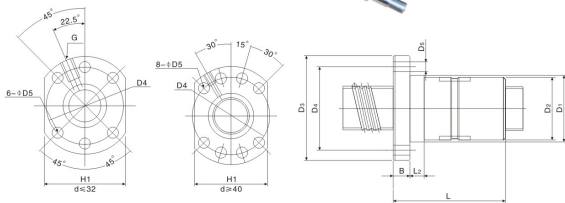

Unit: mm

Model No.	Dia-meter	Pitch	Ball Diameter	Flange Type	Cycle Number	Nut Installation Size										Rated Load (KN)	
						D1(g6)	D2(g6)	D3	D4	D5	L	L2	B	G	H1	Dynamic Load Co.	Static Load Co.
DFU1604-3	16	4	2.381	d≤32	3	28	\	48	38	5.5	72	\	10	M6	40	4.35	9.2
DFU1605-3	16	5	3.175	d≤32	3	28	27.8	48	38	5.5	80	10	10	M6	40	7.65	13.2
DFU2005-3	20	5	3.175	d≤32	3	36	35.8	58	47	6.7	82	10	10	M6	44	8.6	17.1
DFU2505-3	25	5	3.175	d≤32	3	40	39.5	62	51	6.6	82	10	10	M6	48	9.8	23
DFU3205-3	32	5	3.175	d≤32	5	50	49.5	80	65	9	102(106)	10	12	M6	62	16.9	51
DFU3210-3	32	10	6.35	d≤32	3	50	49.5	80	65	9	135	16	12	M8X1	62	26.1	53.1
DFU4005-4	40	5	3.175	d≥40	5	63	62.5	93	78	9	105	10	14	M6	70	19	66.2
DFU4010-4	40	10	6.35	d≥40	3	63	62.5	93	78	9	165	16	14	M8X1	70	30.1	71
DFU5010-4	50	10	6.35	d≥40	4	75	74.5	110	93	11	163	16	16	M8X1	85	53.1	155
DFU6310-4	63	10	6.35	d≥40	5	90	\	125	108	11	182	\	18	M8X1	95	60.7	206
DFU8010-4	80	10	6.35	d≥40	5	105	\	145	125	13.5	182	\	20	M8X1	110	66.6	265